

1 Warning

⚠ Installation

Installation and removal of the device shall be done by trained professional only!

2 Installation

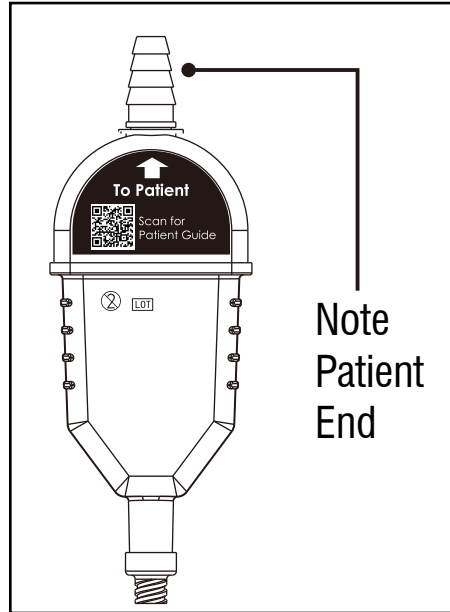

3 Installation

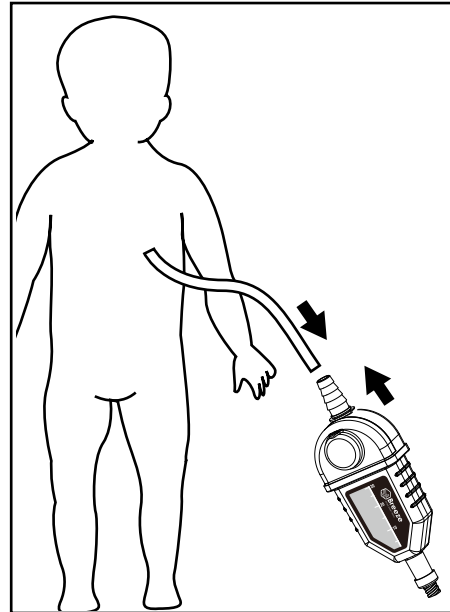

4 Installation

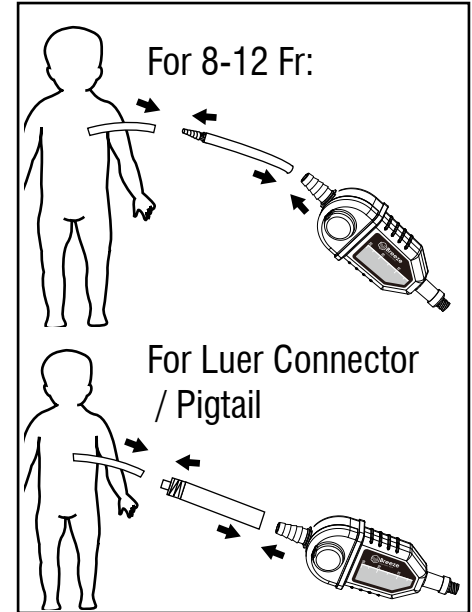

5 Warning for Use

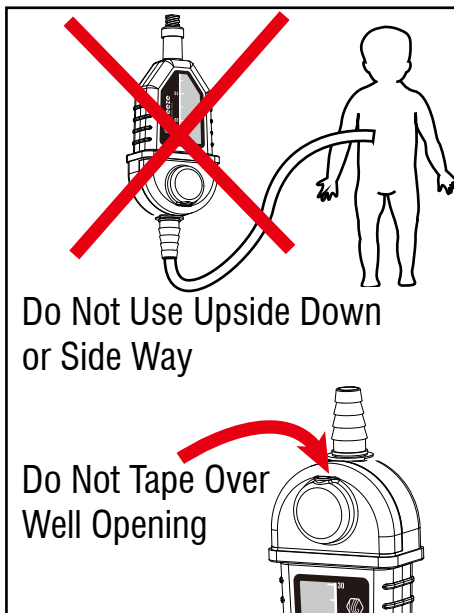

6 Air Leak Monitoring

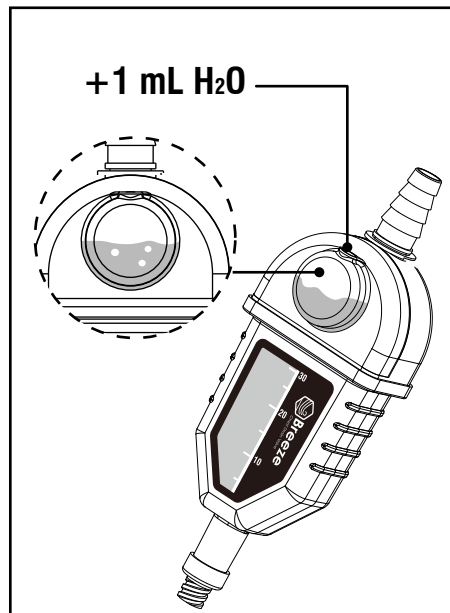

7 Sampling

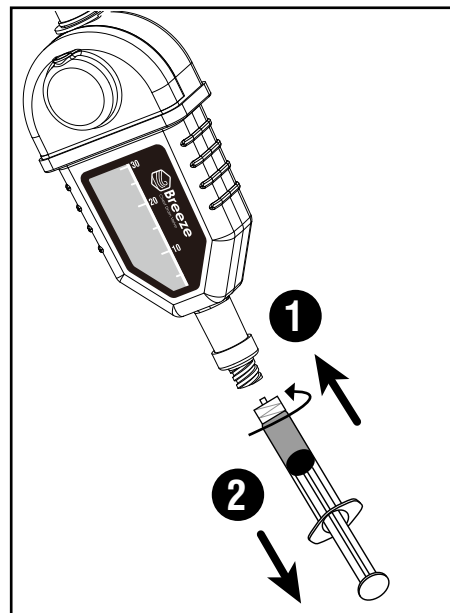

8 Disposal

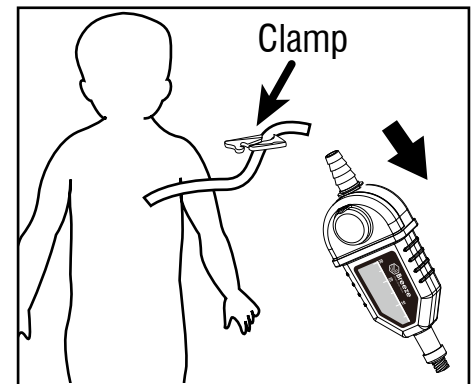

Breeze Chest Drain Valve | **vide** by Alleva Medical

BREEZE CHEST DRAIN VALVE

REF: ST425-0001

